



Contact Us

Ty Whittaker

Personal Real Estate Corporation

Executive Vice President

250 414 8395

ty.whittaker@colliers.com

FOR SUBLEASE | 120 - 1759 Sean Heights, Saanichton | BC

Suburban Business Park Space at Raven's Landing

Raven's Landing Business Park is the newest and most modern industrial building in the Keating Industrial Park.

9,436 SF unit available.

Colliers International

1175 Douglas Street, Suite 1110

Victoria, BC | V8W 2E1

+1 250 388 6454

www.collierscanada.com



Location

Located in the Keating Industrial Park, 20 minutes north of downtown Victoria. This central location offers excellent access to Pat Bay Highway, servicing Schwartz Bay and Victoria International Airport to the north. Raven's Landing sits on +/-4.5 acres of land and has been developed in phases with ample parking.

Zoning

I-1 Light Industrial Zone.

Permitted uses include, but are not limited to: wholesale, warehousing, light industrial manufacturing, building supply sales, vehicle servicing, machine shops, high tech, and business offices.

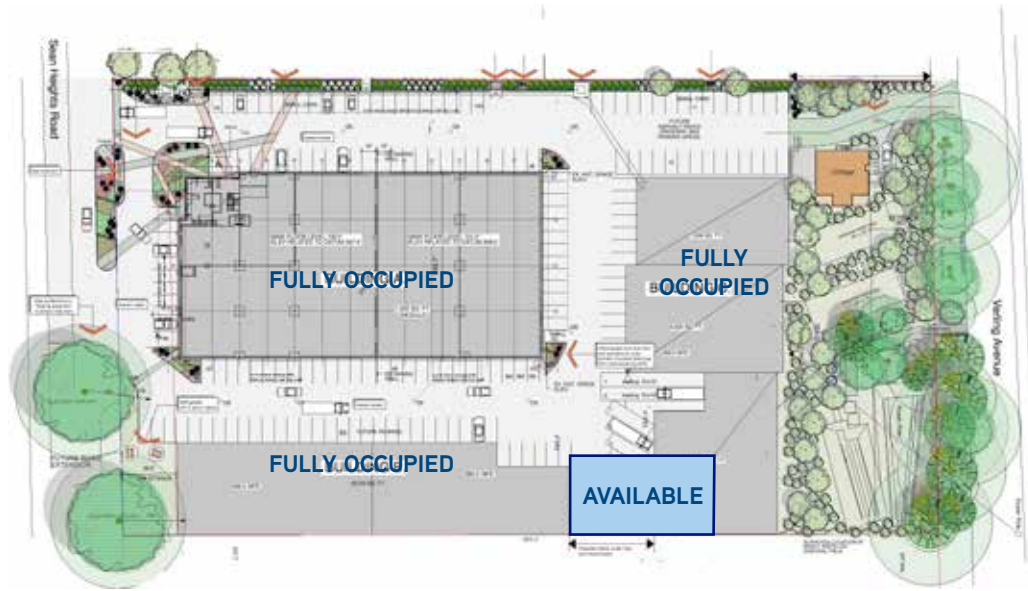

Highlights

- Concrete tilt-up construction
- 5 Grade level loading doors
- Ceiling heights 22' clear
- Natural gas heating
- Ample parking
- Mezzanine offices
- Green building features
- Existing 10 ton crane

Details

- Unit 120
- Unit Size: 9,436 SF
- Lease Rate: \$16.00 PSF net
- Op. Costs/Taxes: \$4.00 PSF (2019)



COLLIERS INTERNATIONAL
1175 Douglas Street, Suite 1110
Victoria, BC | V8W 2E1
+1 250 388 6454
www.collierscanada.com



This document/email has been prepared by Colliers International for advertising and general information only. Colliers International makes no guarantees, representations or warranties of any kind, expressed or implied, regarding the information including, but not limited to, warranties of content, accuracy and reliability. Any interested party should undertake their own inquiries as to the accuracy of the information. Colliers International excludes unequivocally all inferred or implied terms, conditions and warranties arising out of this document and excludes all liability for loss and damages arising there from. This publication is the copyrighted property of Colliers International and /or its licensor(s). © 2019. All rights reserved. This communication is not intended to cause or induce breach of an existing listing agreement. Colliers Macaulay Nicolls Inc.